

## Operating Instruction- LED Flashing Write-on Boards

Thanks for choosing the Green Edge LED Write-on writing board. Please read this manual thoroughly before using this product.

### The product components:

The accessories that come with the led write-on board include: two cleaning cloth, a power adapter, a manual controller, a remote controller, a hanging chain and two hanging hooks that are already installed on the board,

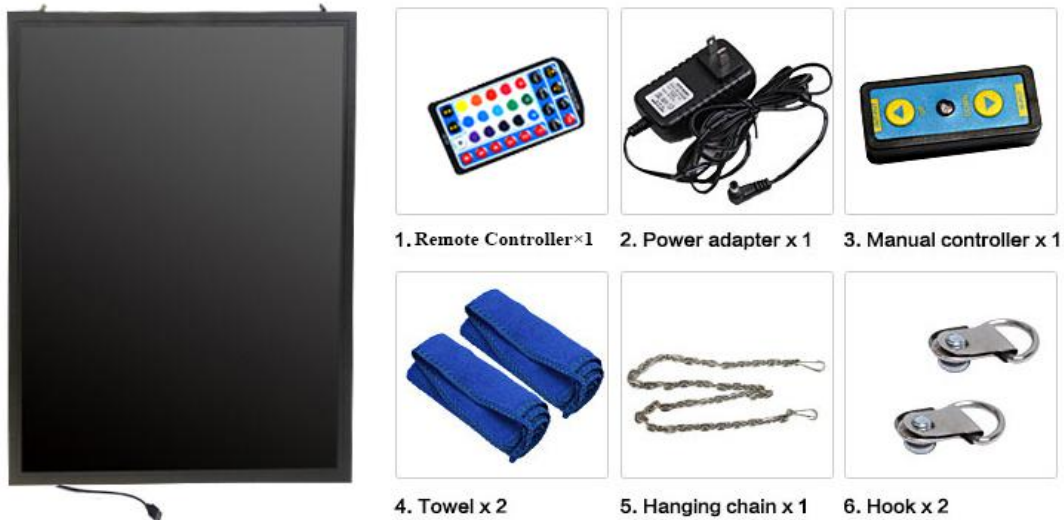

### How to use the led writing board?

#### 1. Connecting to power

Connect the power adapter to the manual controller, and then the other port of the manual controller to the wire that runs out of the LED board as seen in the diagram below:.



#### 2. Write message on the board by marker pen.

- ① Write text or draw pictures on the board using window glass neon markers available in most office supply stores.
- ② Please allow 1 to 2 minutes for the ink to dry.

#### 3. Controlling the LED board using the remote control:

The remote control allow setting the board to 90 flashing modes as well as turning the LED board On and Off.

# Remote Control

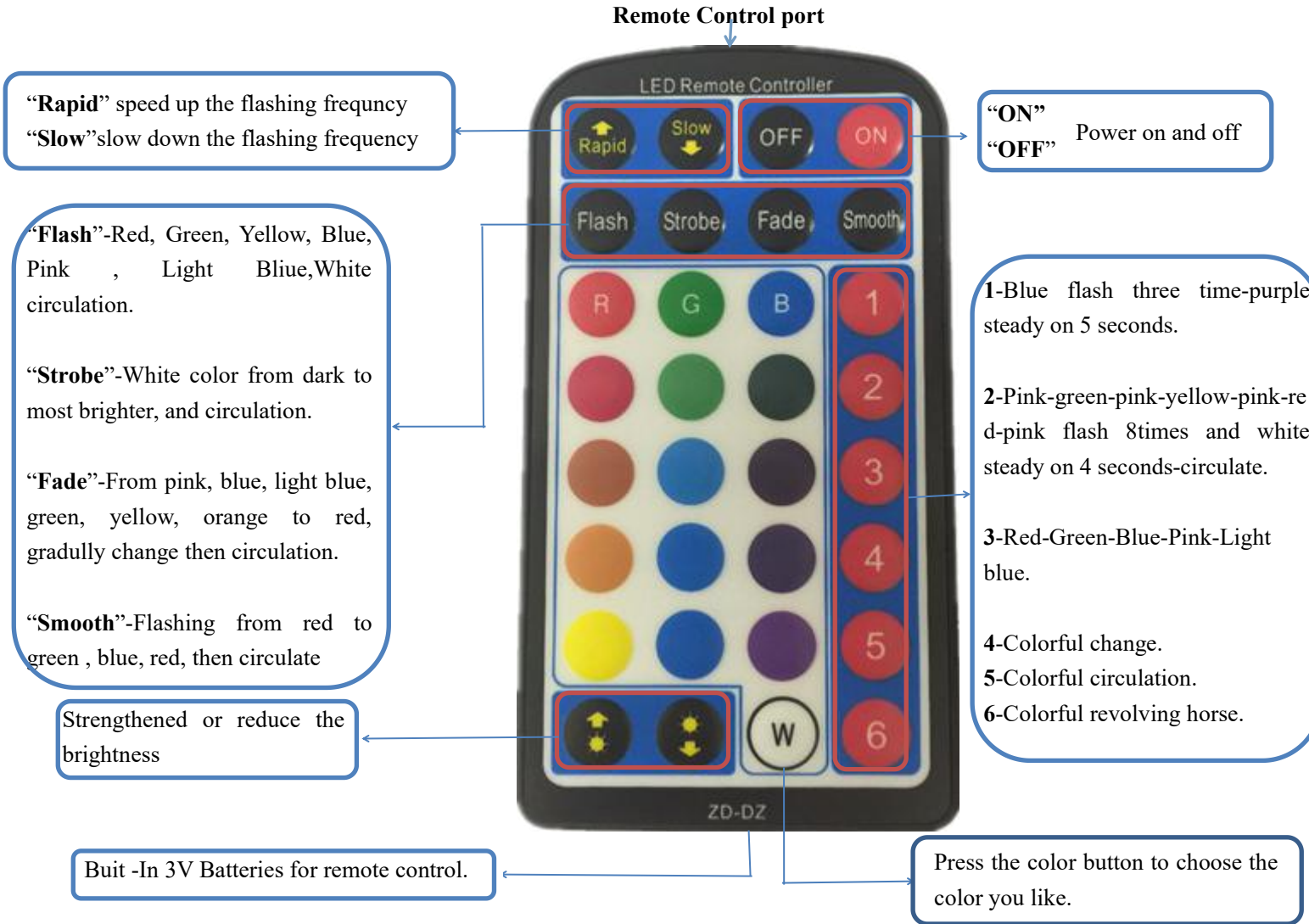

#### 4. Controlling the LED board using the manual controller:

### Manual Control

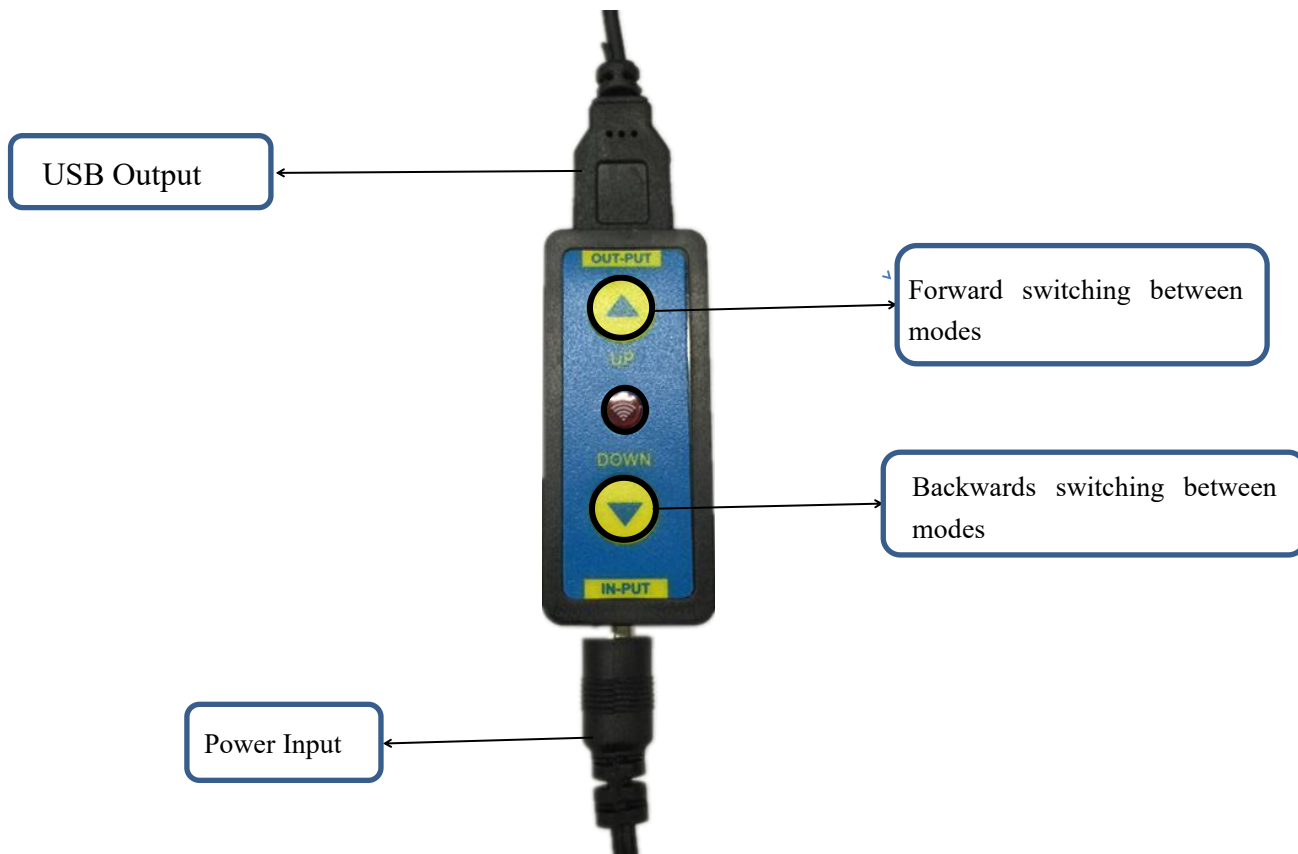

### NOTE:

There are 18 types of flashing modes when using the manual controller to control the LED board..  
Following are the different modes of the manual controller:

1. Backlight - Red
2. Backlight - Green
3. Backlight - Blue
4. Backlight - White
5. Fast speed switching (red,green,blue,purple)
6. Middle speed switching (white)
7. Fade In (red,green,blue, purple,white)
8. Blinking (red,green,blue)
9. Switching between purple and yellow
10. Blinking (red,green,blue)
11. Slow switching (red,green,blue,white,yellow)
12. Blinking (red,green,blue)
13. Blink and stop (red,green,blue,purple ,stop)
14. Blinking (red,green,blue)
15. Light blue
16. Purple
17. Orange
18. red green switching

## 5.How to use the Window Glass neon markers?

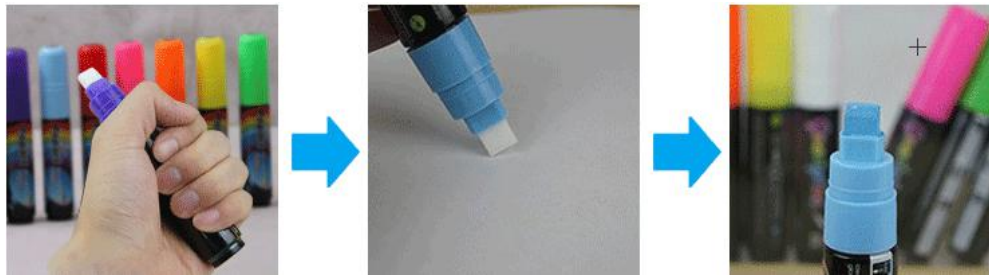

1. Shake the marker with the cap on.
2. Remove the cap and press the nib several times until the tip is filled with ink.
3. Write anything you like on the led writing board.
4. After use, put on the cap back on the marker tightly.
- 5.Keep it horizontally

### **Caution !**

- Unplug the power before cleaning the board
- Never wipe the board surface with dry paper, news paper, or rough surfaced towels
- Keep the board away from the water or any other liquid since the board is non water-proof.
- Keep the board away from direct sunlight or any other heat source.